

If you have questions or would like a copy of any of the following brochures, please contact Community Services at 913/895-6270.

Information to Help You

- Exterior Maintenance of Structures
- Exterior Storage of Items
- Fence Regulations
- Garage Sales
- Gravel Driveway Regulations
- Home Improvement Assistance Guide
- Home Occupations
- Household Trash
- Neighborhood Conservation Program
- Community Services
- Preventing Rat Infestation
- Property Maintenance
- Property Maintenance Checklist
- Tall Grass and Weeds
- Temporary Signs
- Vehicles

Feb 2012
Community Services Division
8500 Antioch, Overland Park, KS 66212
Ph. 913/895-6270 Fax 913/895-5084
<http://www.opkansas.org>

Exterior Storage Items

Community Services

Guidelines for Residents

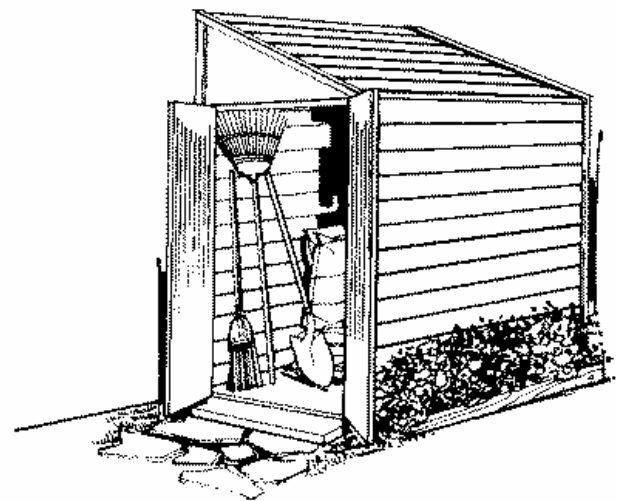

Planning and Development Services Department

OVERLAND PARK
K A N S A S

ABOVE AND BEYOND. BY DESIGN.

Exterior Storage of Items

Every citizen has the responsibility to keep residential neighborhoods clean and attractive. This brochure highlights the exterior storage of items section of the city's property maintenance ordinance and can be used to help you recognize potential property maintenance violations on your property.

The items include household items that you may have an use for now or in the future. They may include trash containers or bags, barrels, ladders, carts, lawn mowers or other lawn and garden equipment, tires, and appliances.

Storage of such items shall be permitted only to the extent that it is an accessory to the residential use of the property; storage related to any business activity shall not be permitted. (Chapter 18.390.140. G.4)

How should I store these items?

- Items must be stored within a fully enclosed structure (your home or garage) or in the back yard if they are substantially screened from view from any adjacent property by a fence or wall. A shed less than 200 square feet may be used for tools and lawn equipment.
- Portable storage units are not allowed.
- Items may not occupy more than 20 percent of the area of the rear yard.
- Items must be stored in such a manner as to discourage harborage of rodents, insects and other pests.

*How should I store my trash containers?

Trash containers must be screened from view

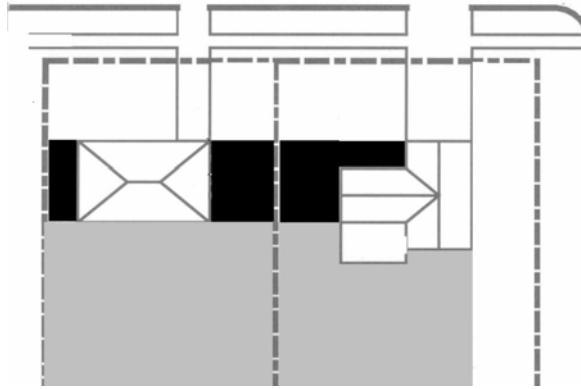

- **Exterior items** may be stored in the gray area but must be screened from view. Storage is limited to no more than 20 percent of the gray area.
- **Trash containers or bags** can be stored in the gray or black areas and must be screened from view.
- **Firewood** can be stored in the gray or black areas and is exempted from the screening

from any street or neighboring property and be located behind the front building line of the house. In the case of a corner lot, trash containers can't be located in the side yard adjacent to a street. Trash containers can also be stored in a fully enclosed structure.

Are there any exceptions?

Yes. Some items related to approved accessory uses for residentially zoned property are exempt from the screening requirement. Firewood and play equipment are considered exempt items. Firewood must be stored behind the front building line. On a corner lot, firewood must be stored behind the front and side building lines. Firewood must be free of insects and stacked neatly.

Is there a penalty for improper exterior storage of items?

Yes. Failure to comply with the storage requirements discussed here is a violation of the Overland Park Municipal Code. A ticket may be issued each day the violation remains and be subject to a fine up to \$500 per ticket or six months imprisonment, or both.

Exterior Storage Guidelines

Items Exempt from Screening Requirements are:

- Firewood
- Play equipment

Items That Require Screening include but are not limited to:

- Trash containers or bags
- Lawn and garden equipment:
 - Garden tools
 - Lawn mowers
 - Wheelbarrows
- Tools
- Ladders
- Saw horses
- Vehicle parts
- Building material:
 - Cement blocks
 - Lumber
 - Plywood, etc.
- Storm windows and awnings
- Camper shells
- Dirt, sand and gravel (30 day limit)